



## **FERELLA FREE F24 MEL**

*LISTA PEZZI DI RICAMBIO*

*SPARE PART LIST*

*ERSATZSTEILE*

*LIJST ONDERDELEN*

*LISTE PIECES DETACHES*

*LISTA PIEZAS DE REPUESTO*

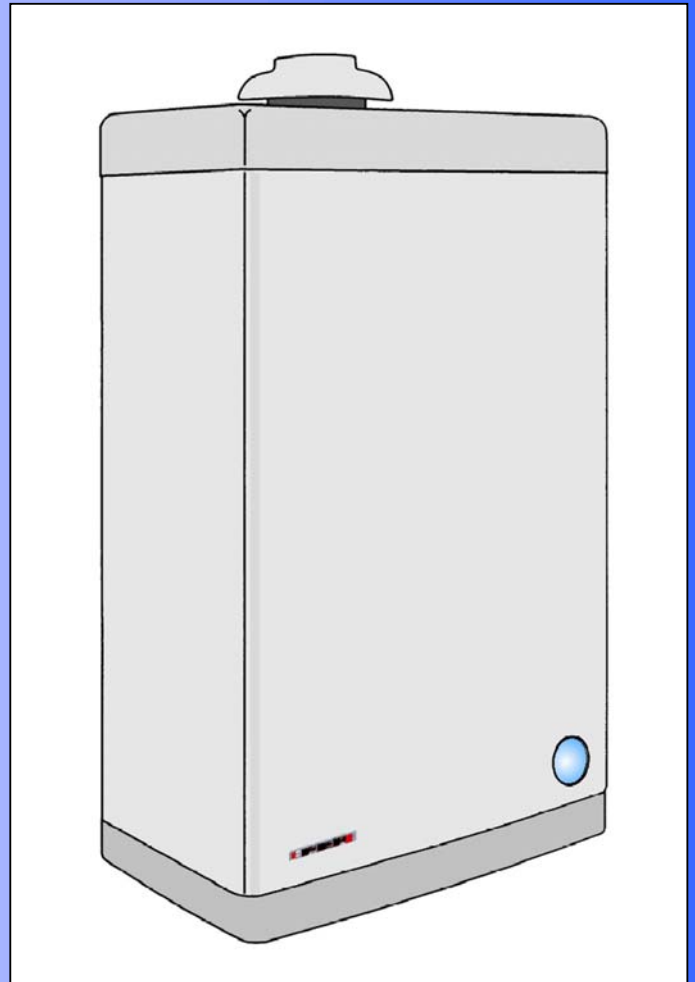

**CODICE**

**30K0193001**

**EDIZIONE**

**01/05/2005**

**MERCATO**

**IT**

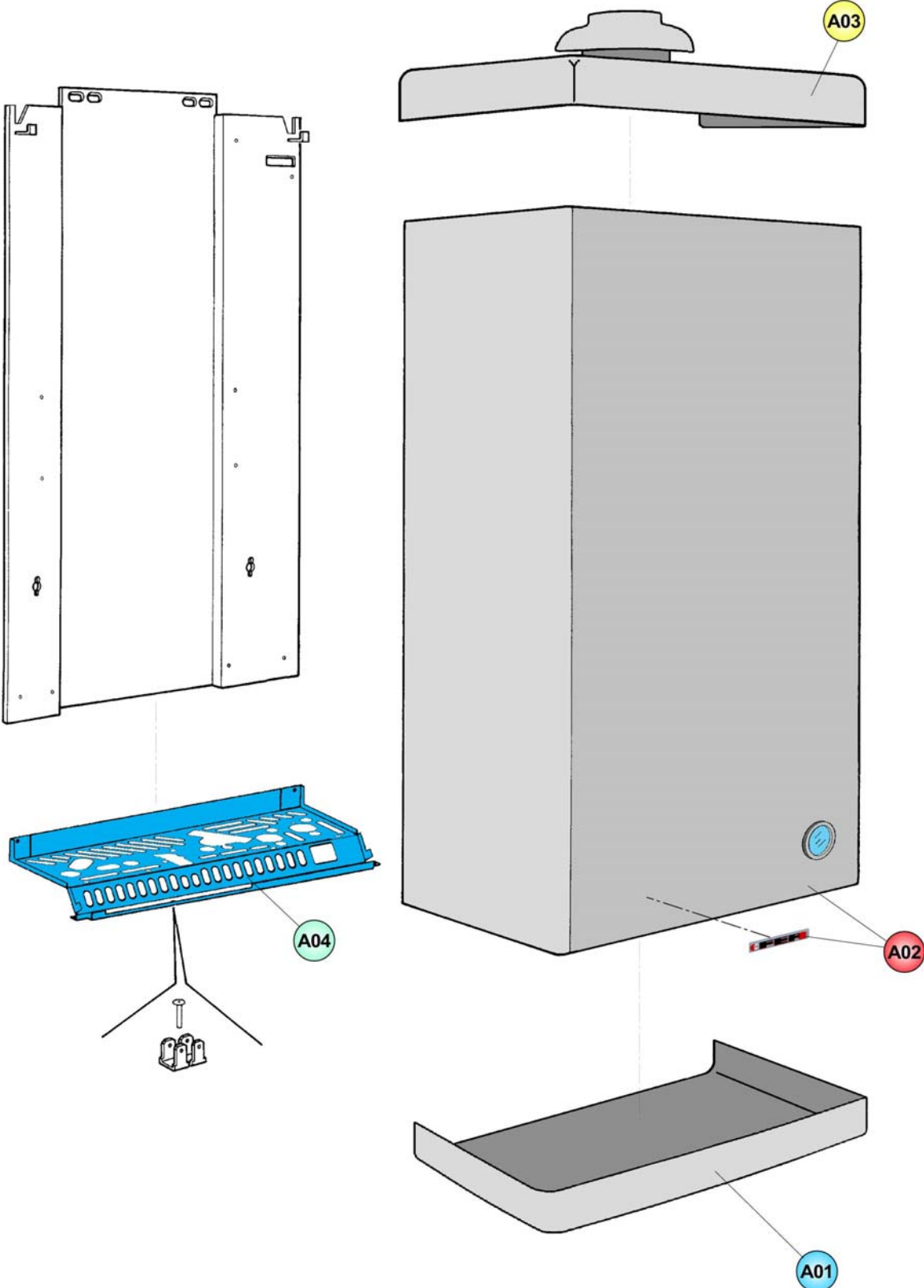

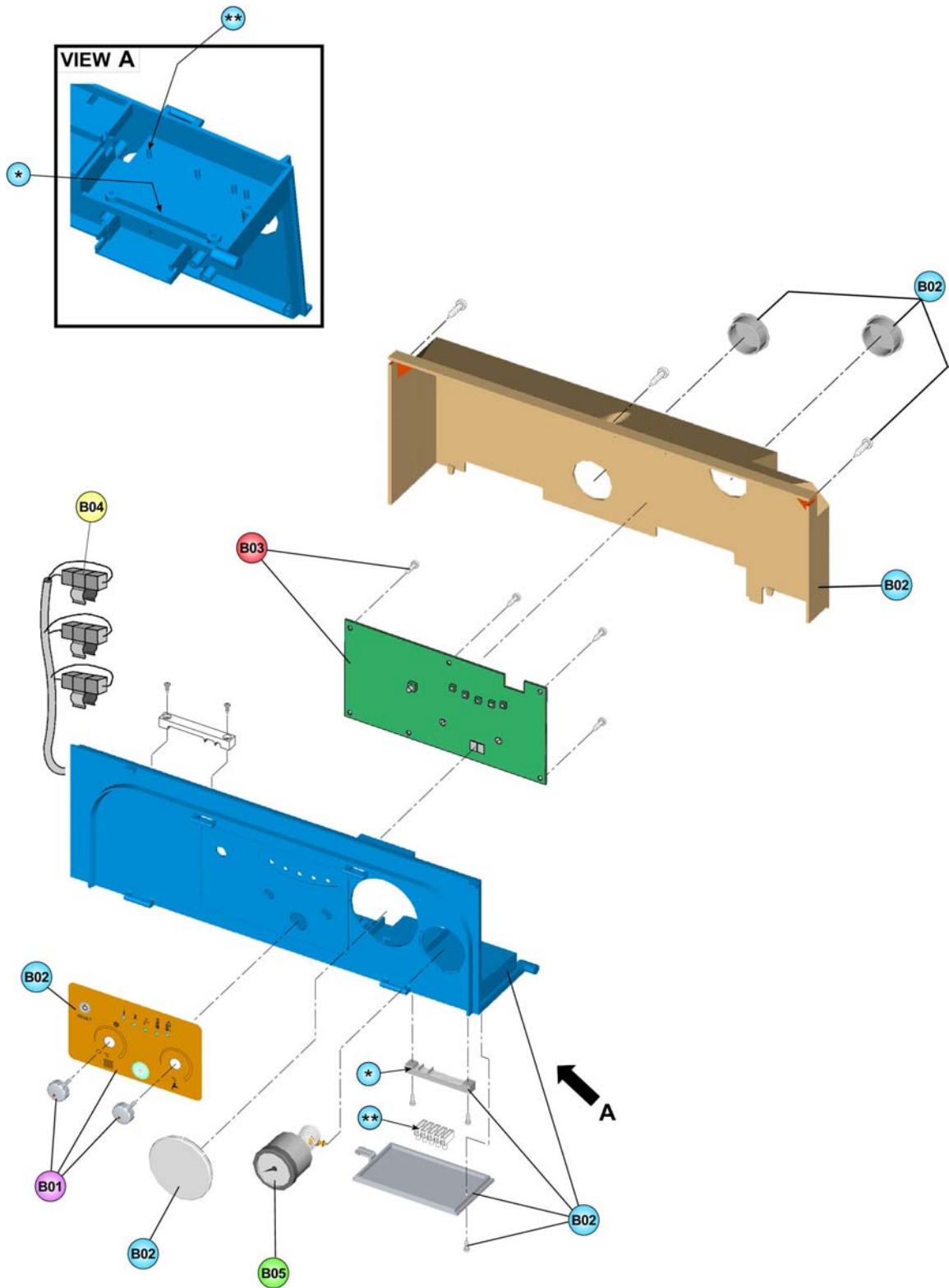

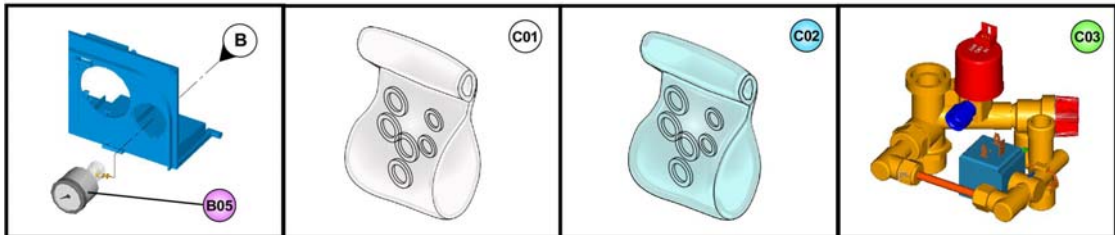
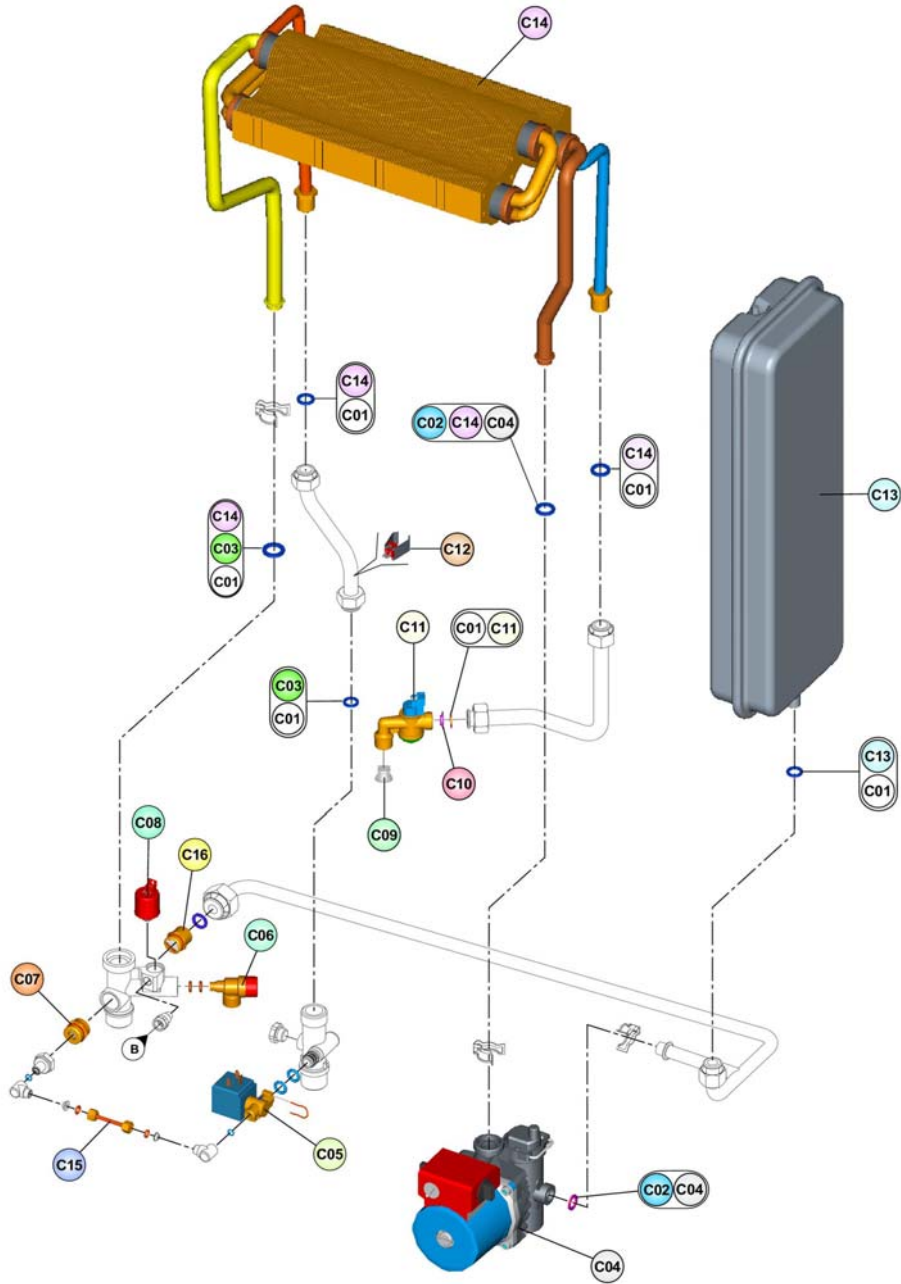

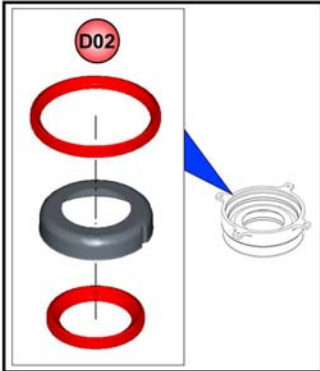
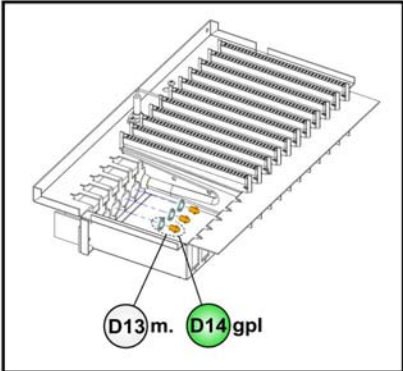
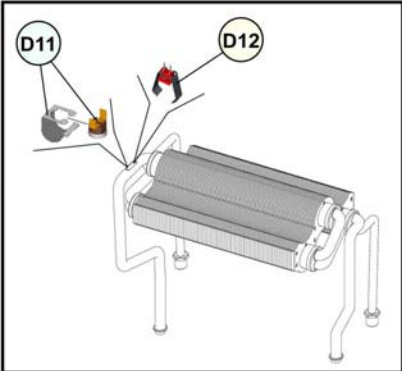
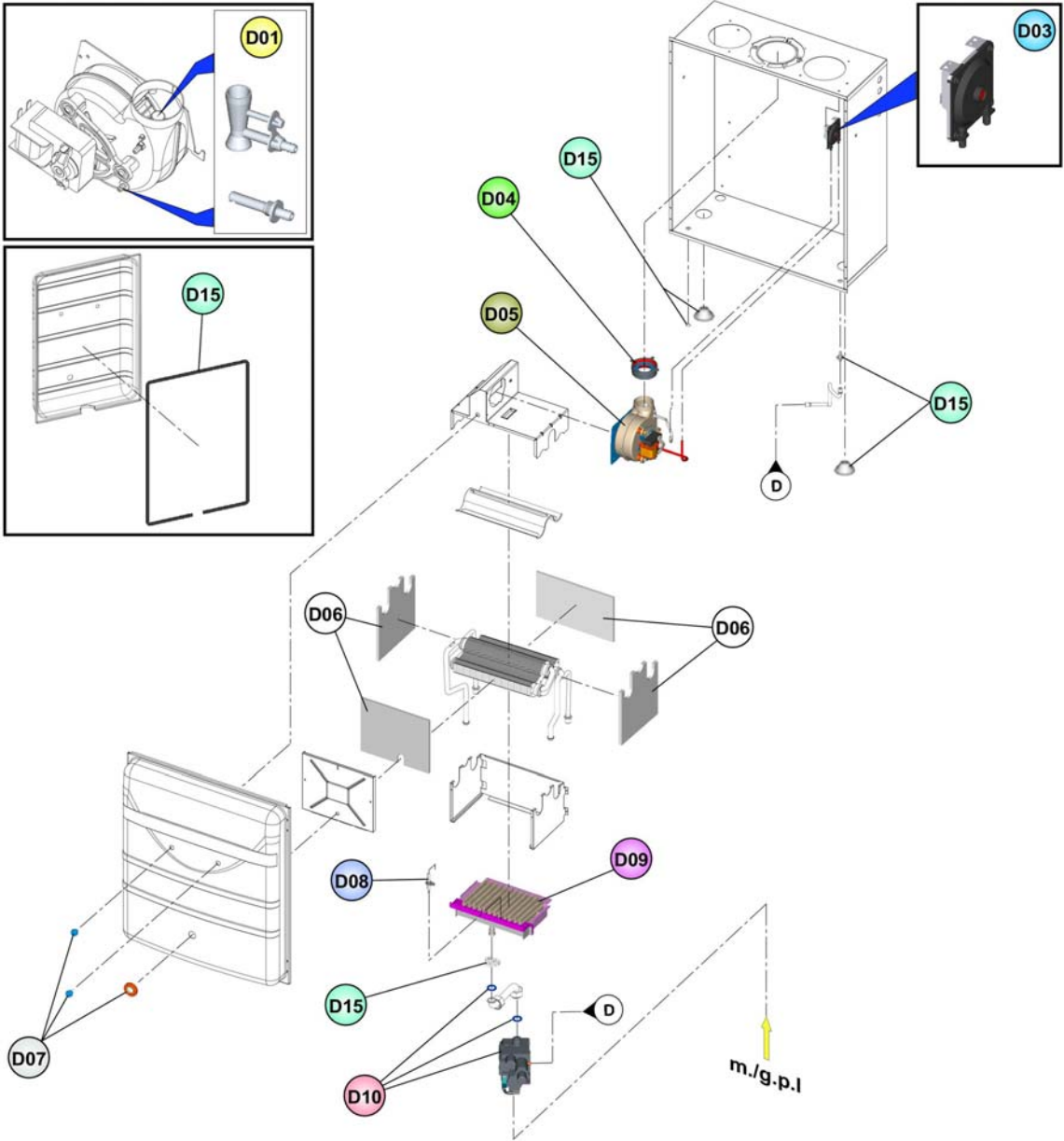

## LISTA PEZZI

POS.	CODICE	DESC.	QT.
A01	39814260	KIT COPERCHIO INF. (3510930)	1
A02	39814240	KIT MANTELLO "Fer" (31146870)	1
A03	39814250	KIT COPERCHIO SUP. (35007820)	1
A04	39814220	KIT FONDO TELAIO (31214320)	1
B01	39811390	KIT MANOPOLE POTENZ. (35007210)	1
B02	39811400	KIT SCATOLA EL.A1G6 (36507170)	1
B03	39811410	KIT CENTRALINA (36507740)	1
B04	39804190	KIT ANTIGELO SANIT."GRUPPO F"	1
B05	39806330	KIT IDROMETRO (36400190)	1
B05	39806330	KIT IDROMETRO (36400190)	1
C01	39812340	KIT GUARNIZ.H2O (da 3/8"a 1")	1
C02	39811420	KIT GUARNIZ.CALD.Sr.A204-A1G6	1
C03	39814280	KIT GRUPPO H2O (38424610)	1
C04	39808290	KIT POMPA WILO (36601500)	1
C05	39809780	KIT VALV. CARIC. AUT. (36900420)	1
C06	39809740	KIT VALV. SIC. (39400540)	1
C07	39814270	KIT VALV. N/RIT. (39404150)	1
C08	39809470	KIT TRASDUTTORE (36400380)	1
C09	39812310	KIT N°5 FILTRI H2O (35007480)	1
C10	39801220	KIT 5 REG.PORT.10Lt. (36901030)	1
C11	39807580	KIT FLUSSOM (36400320-36901030)	1
C12	39810230	KIT SONDA TEMP. SAN. (36200640)	1
C13	39804890	KIT VASO ESP.8Lt. (36802641)	1
C14	39811550	KIT PACCO LAM. (37403440)	1
C15	39818060	KIT TUBO ALIM.RUB. (39404410)	1
C16	39818080	KIT VALV.BY-PASS (39404130)	1
D01	39808471	KIT PRESE (35101310-35101323)	1
D02	39808670	KIT DIAFRAMMI FUMI D.45-47-50	1
D03	39805630	KIT PRESS. DIFF. ARIA (36400060)	1
D04	39808750	KIT RACC. COLL. VENT. (32117090)	1
D05	39811561	KIT VENTIL.-PIASTRA Sr.A2F4	1
D06	39811570	KIT ISOL.CAM.COMB.Sr.A2C4-A2F4	1
D07	39811330	KIT SPIA SILICONE (35102230)	1
D08	39808800	KIT ELETTR. (36702470-36702581)	1
D09	39806950	KIT CASSETTO 12R. (37608130)	1
D10	39804880	KIT VALV.VK4105G (36802720)	1
D11	39805650	KIT TST.C.ARG.100°C (36400900)	1
D12	39810220	KIT SONDA TEMP.RISC. (36200540)	1
D13	39805760	KIT 12 UG.ES7 F.1,30 (EL)	1
D14	39804780	KIT 12 UG.ES7 F.0,77 (EL)	1
D15	39814210	KIT GUARN.+PRESA ARIA Sr.A2F4	1